









Rettangolare fisso - Rectangular not adjustable

P.396

-  **Materiale - Material**
Corpo in policarbonato, Parabola in poliammide
Polycarbonate body, Polyamide reflector
-  **Colore - Colour**
Corpo semitrasparente - Semitransparent body
Interruttore grigio - Grey button
-  **Pezzi confezione - Package items**
50 pezzi - pieces
-  **Volume confezione - Package volume**
24,3 dm³
-  **Peso confezione - Package weight**
3.000 g
-  **Intensità luminosa - Light intensity**
vedi sez. tecnica - see technical section
-  **Temp. di esercizio - Working temp.**
-10/+120 °C
-  **Normative - Norms**
R107.8; R118.3; FMVSS 302; ISO 3795; REACH; ROHS; CMR.
More info on page D2-D3 and website on "Directives and regulations" area.



P.396

Cod.

65671



BA 15 S (not included)



included

P.396

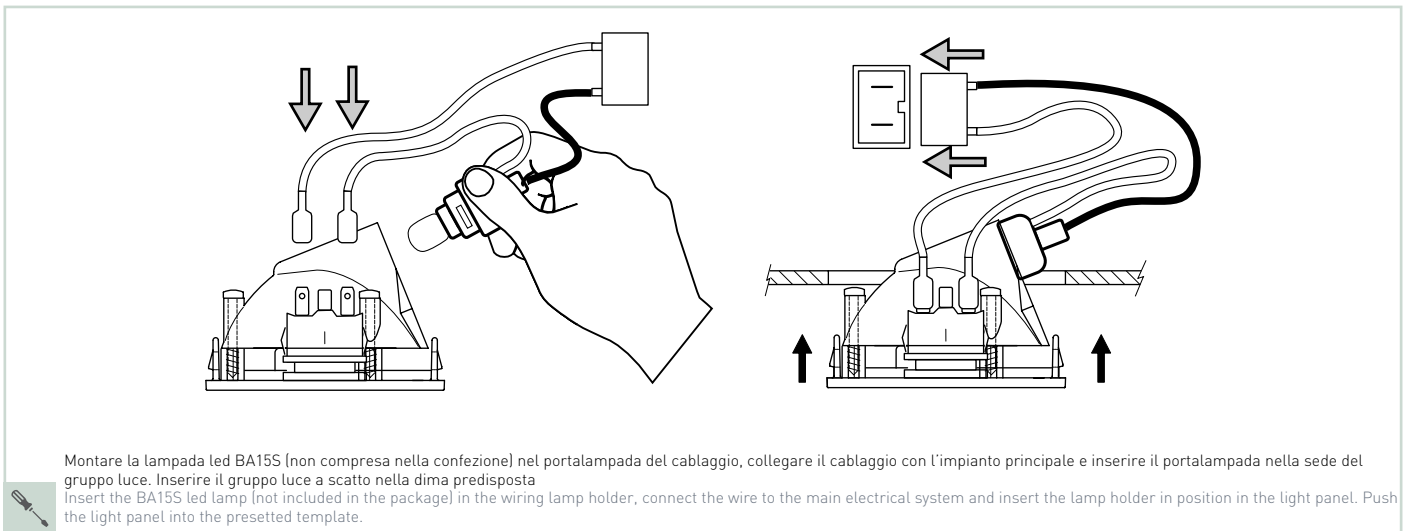
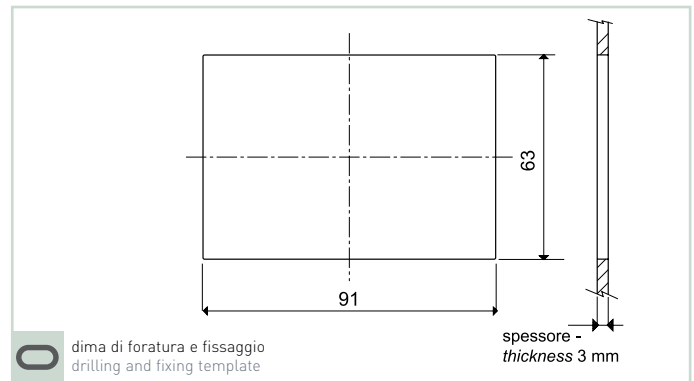
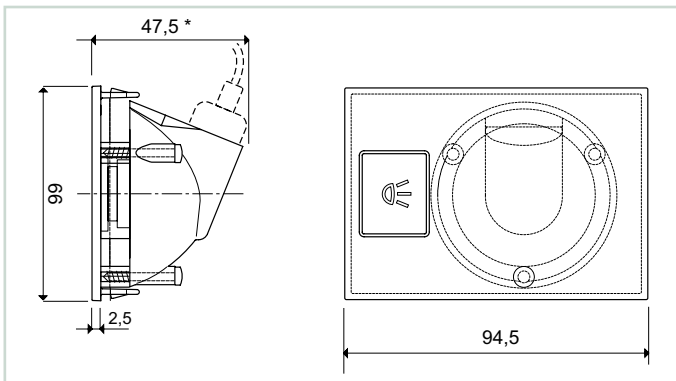

■ Test intensità luminosa - Light intensity test

